

REV	ECN	DESCRIPTION	BY/DATE	CHK	APPR
C	12594	ADDED NOTE 5	JS 03/31/16	LA	AS

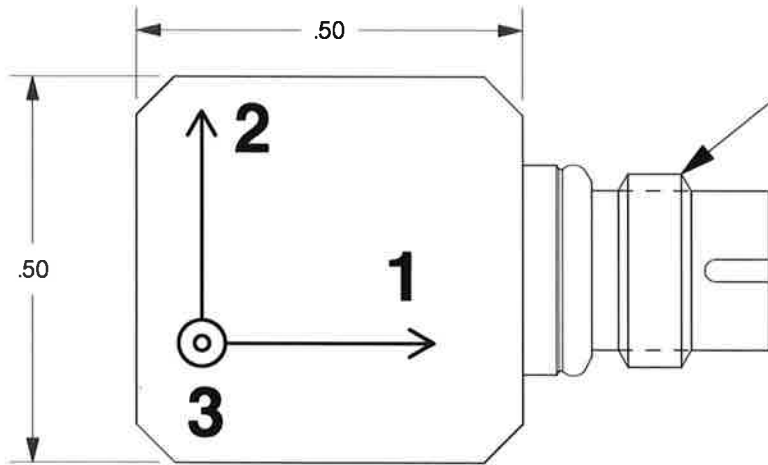

CONNECTOR MATES WITH
DYTRAN CABLE 6430AXX \triangle ₃

PINOUT
 PIN #1 SIG/PWR AXIS 1 (X)
 PIN #2 SIG/PWR AXIS 2 (Y)
 PIN #3 SIG/PWR AXIS 3 (Z)
 PIN #4 GND RETURN, COMMON

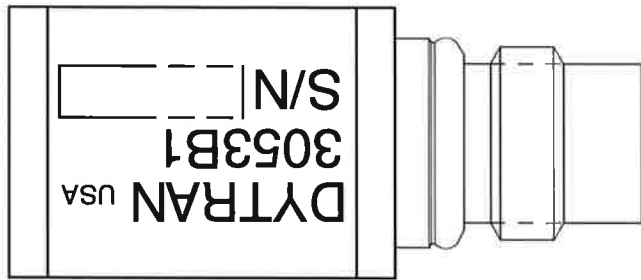
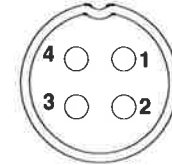

VIEW A-A LOOKING INTO CONNECTOR

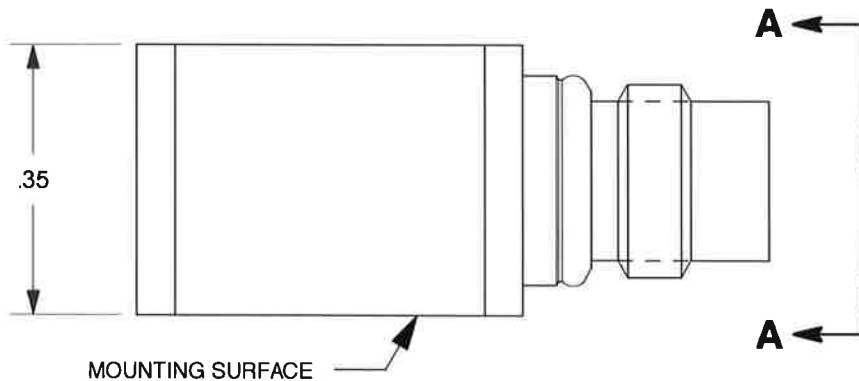

5. MINOR VOIDS, SCARS, SCRATCHES AND MOUNTING BLEMISH WITNESS MARKS ON EXTERNAL SURFACES ARE ALLOWED DUE TO RESTRAINING AND HANDLING DURING TESTING, TRANSPORT OR PROCESSING. THESE APPEAR AS INDICATORS THAT DO NOT AFFECT FORM, FIT OR FUNCTION AS INTENDED BY DESIGN OR APPLICATION.

4. WEIGHT: 6.2 GRAMS.

\triangle ₃ XX=LENGTH IN FEET

2. + SIGNS INDICATE SENSE AND DIRECTION OF ACCELERATION FOR POSITIVE OUTPUT.

1. HOUSING & CONNECTOR MATERIAL: TITANIUM ALLOY

EXCEPT AS OTHERWISE NOTED

ALL DIMENSIONS IN INCHES
 TOLERANCE: .XXX = ± .XX = ± .01

SURFACE FINISH
 EXCEPT AS NOTED \checkmark

BREAK EDGES TO DEBURR
 RADIUS OR CHAMFER

\triangle THESE DIAS \odot TO T.I.R.

FILLET - MAX RAD.

		MASTER ONLY IF IN RED		CHATSWORTH, CA	
SCALE	4X	REV	-	DATE	SEE REV BLK
DATE	8/15/00	PART NO.	127-3053B1		
DRAWN	N.C.	CHECKED	R.A.	MAT'L	-
APPROVED	N.C.	8/15/00	NEXT ASSEMBLY	-	USED ON
TITLE					DWG NO.
OUTLINE INSTALLATION DRAWING, MODEL 3053B1, 5 mV/G					127-3053B1
SHEET 1 OF 1					

MODEL NUMBER 3053B1	PERFORMANCE SPECIFICATION	DOC NO. PS3053B1
	TRIAxIAL ACCELEROMETER, IEPE	REV B, ECN 12559, 03/14/16



- ADHESIVE MOUNT
- HERMETICALLY SEALED
- INTERNALLY CASE GROUND ISOLATED

PHYSICAL

Weight
Mounting Provision [1]
Connector [2]
Material

ENGLISH			SI	
0.22	oz		6.2	grams
Adhesive mount			Adhesive mount	
4-Pin			4-Pin	
Titanium Alloy			Titanium Alloy	

PERFORMANCE

Sensitivity, -10/+15% [3]
Range F.S. (each axis)
Frequency Response, ± 10%
Resonant Frequency
Equivalent Electrical Noise Floor
Linearity [4]
Transverse Sensitivity, Max.
Signal Polarity

ENGLISH			SI	
5	mV/g		0.51	mV/ m/s ²
± 1000	g		± 9810	m/s ²
2 to 5000	Hz		2 to 5000	Hz
>30	kHz		>30	kHz
<0.014	g rms		<0.14	m/s ² rms
± 1	%F.S		± 1	%F.S
5%			5%	
Positive for motion in direction of arrows on housing				

ENVIRONMENTAL

Maximum Vibration
Maximum Shock
Temperature Range
Seal
Coefficient Of Thermal Sensitivity

ENGLISH			SI	
± 600	g		± 5880	m/s ² pk
±5000	gpk		±49000	m/s ² pk
-60 to +250	°F		-51 to 121	°C
Hermetic			Hermetic	
0.03	%/°F		0.054	%/°C

ELECTRICAL

Supply Current [5]
Compliance Voltage Range
Output Impedance Typ.
Bias Voltage
Discharge Time Constant
Ground Isolation

ENGLISH			SI	
2 to 20	mA		2 to 20	mA
+18 to +30	V		+18 to +30	V
100	Ω		100	Ω
9 to 11	VDC		9 to 11	VDC
0.2 to 1.2	sec		0.2 to 1.2	sec
>10	MΩ		>10	MΩ

This family also includes:

Model	Sensitivity (mV/g)	Range (Gpeak)	Resolution (Grms)	Oper. Temp(°F)	TC (sec)
3053B	10	500	<0.007	-60 to +250	0.3 - 1.0

Refer to the performance specifications of the products in this family for detailed description.

Supplied Accessories

- 1) Accredited calibration certificate (ISO 17025)

Notes:

- [1] Case ground isolation is achieved by internal means.
- [2] Connector mates with Dytran cable assy. Model 6430AXX. (XX = length in feet)
- [3] Reference sensitivity measured at 100 Hz, 1 G RMS per ISA RP 37.2
- [4] Linearity is % of specified full scale (or any lesser full scale range), zero-based best fit straight line method.
- [5] Do not apply power to this device without current limiting, 20mA max, to do so will destroy the integral IC amplifier

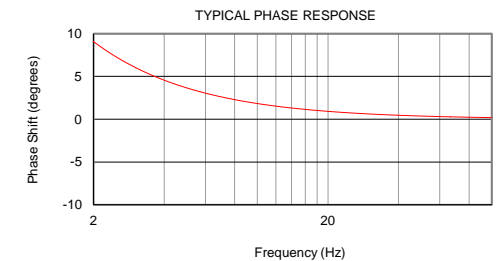
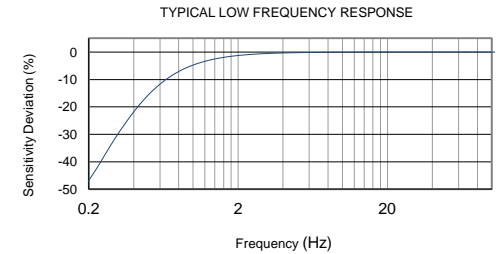
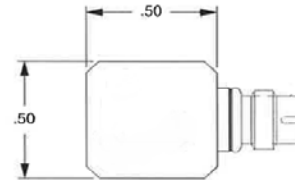

Units on the line drawing are in inches, units in brackets are in millimeters. Refer to 127-3053B1 for more information.



21592 Marilla Street, Chatsworth, California 91311 Phone: 818.700.7818 Fax:818.700.7880
www.dytran.com For permission to reprint this content, please contact info@dytran.com